

BOLT ISOLATION WASHER BUSHINGS

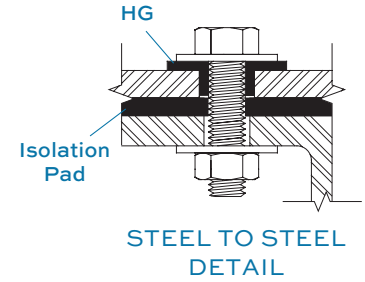

MATERIAL:
BRIDGE BEARING
NEOPRENE

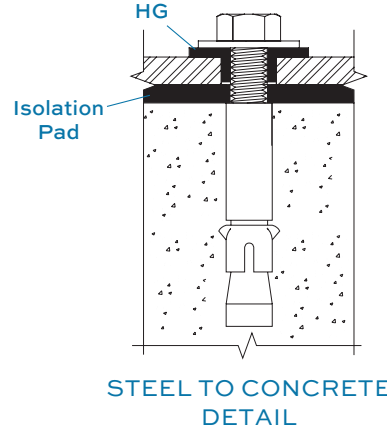
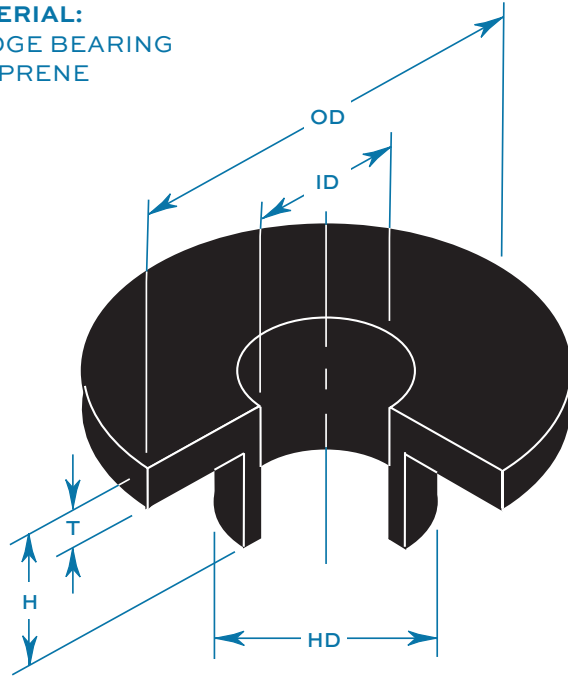

BOLT ISOLATOR AND SEISMIC RELIEF APPLICATION

HG Washer Bushings may be used without isolation pads to limit bolt shear from impact

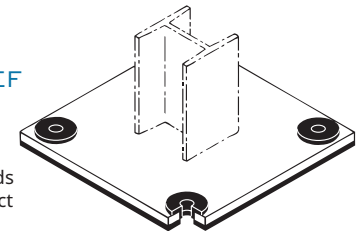

TYPE HG DIMENSIONS

Type & Size	Bolt Diameter*		Allowable Shear Load in a Steel to Steel Connection		Allowable Tension Load in a Steel to Steel Connection		ID		HD		OD		T		H	
	(in)	(mm)	(lb)	(kg)	(lb)	(kg)	(in)	(mm)	(in)	(mm)	(in)	(mm)	(in)	(mm)	(in)	(mm)
HG-25	1/4	6	490	222	980	445	1/4	6	1/2	13	1	25	1/8	3	3/8	10
HG-38	3/8	10	1100	499	2200	998	3/8	10	5/8	16	1 1/4	32	1/8	3	1/2	13
HG-50	1/2	13	1960	889	3920	1778	1/2	13	3/4	19	1 5/8	41	1/8	3	1/2	13
HG-63	5/8	16	3070	1393	6140	2785	5/8	16	7/8	22	2	51	3/16	5	5/8	16
HG-75	3/4	19	4420	2005	8840	4010	3/4	19	1	25	2 1/4	57	3/16	5	5/8	16
HG-100	1	25	7850	3561	15700	7121	1	25	1 1/4	32	2 3/4	70	1/4	6	7/8	22
HG-125	1 1/4	32	12270	5566	24540	11131	1 1/4	32	1 1/2	38	3 1/4	83	1/4	6	7/8	22
HG-150	1 1/2	38	17670	8015	35340	16300	1 1/2	38	1 3/4	45	3 3/4	95	1/4	6	1	25

*Retention strength based on diameter of anchor bolt and anchoring method.

AASHTO BRIDGE BEARING SPECIFICATIONS FOR NEOPRENE

ORIGINAL PHYSICAL PROPERTIES			TESTED FOR AGING				COMPRES- SION SET
Tests: ASTM D-2240 & D-412			Oven Aging (70hrs/212°F) ASTM D-573			Ozone ASTM D-1149	ASTM D-395
Duro- meter Shore A	Tensile Strength (min)	Elongat. at Break (min)	Hard- ness (max)	Tensile Strength (max)	Elongat. at Break (max)	100 pphm in air by Vol. 20% Strain 100°F	22 hrs/212°F Method B
40±5	2000 psi	450%	15	-15%	-40%	No Cracks	30% (max)
50±5	2250 psi	400%	15	-15%	-40%	No Cracks	35% (max)
60±5	2250 psi	350%	15	-15%	-40%	No Cracks	35% (max)
70±5	2250 psi	300%	15	-15%	-40%	No Cracks	35% (max)

NOTE: 40 Durometer is not included in AASHTO Specifications.
Numbers are Mason standard.